

## Property Description

**Guide Price: £200,000 - £210,000**

Located in this popular area this one bedroom first floor flat is decorated to an excellent standard throughout. The property internally offers ample storage space as well as balcony which is accessible via the living room. There is a parade of shops near by as well as two good primary schools and popular public transport links leading to both Romford and Harold Wood.

### First Floor

Hallway

Storage Cupboards

Living Room – 15'07" x 10'10"

Balcony

Kitchen – 10'08" x 7'06"

Bedroom – 15'07" x 8'02"

Communal Gardens

Disclaimer: Information provided about this property does not constitute or form part of an offer or contract, nor may be it be regarded as representations. All interested parties must verify accuracy and your solicitor must verify tenure/lease information, fixtures & fittings and, where the property has been extended/converted, planning/building regulation consents. All dimensions are approximate and quoted for guidance only as are floor plans which are not to scale and their accuracy cannot be confirmed. Reference to appliances and/or services does not imply that they are necessarily in working order or fit for the purpose.

"Our Service is Key"

**1 Bedroom  
Apartment**

**Guide Price £200,000  
Hitchin Close, Romford, RM3 7EG**



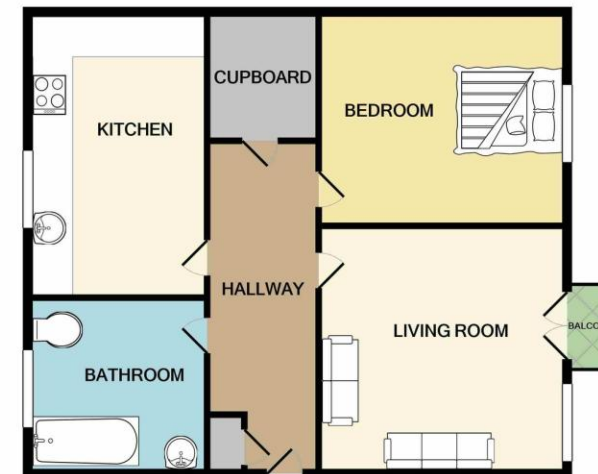

Whilst every attempt has been made to ensure the accuracy of the floor plan contained here, measurements of doors, windows, rooms and any other items are approximate and no responsibility is taken for any error, omission, or mis-statement. This plan is for illustrative purposes only and should be used as such by any prospective purchaser. The services, systems and appliances shown have not been tested and no guarantee as to their operability or efficiency can be given.  
Made with Metropix ©2021